

BUILDING 3 PLAN

Building 2

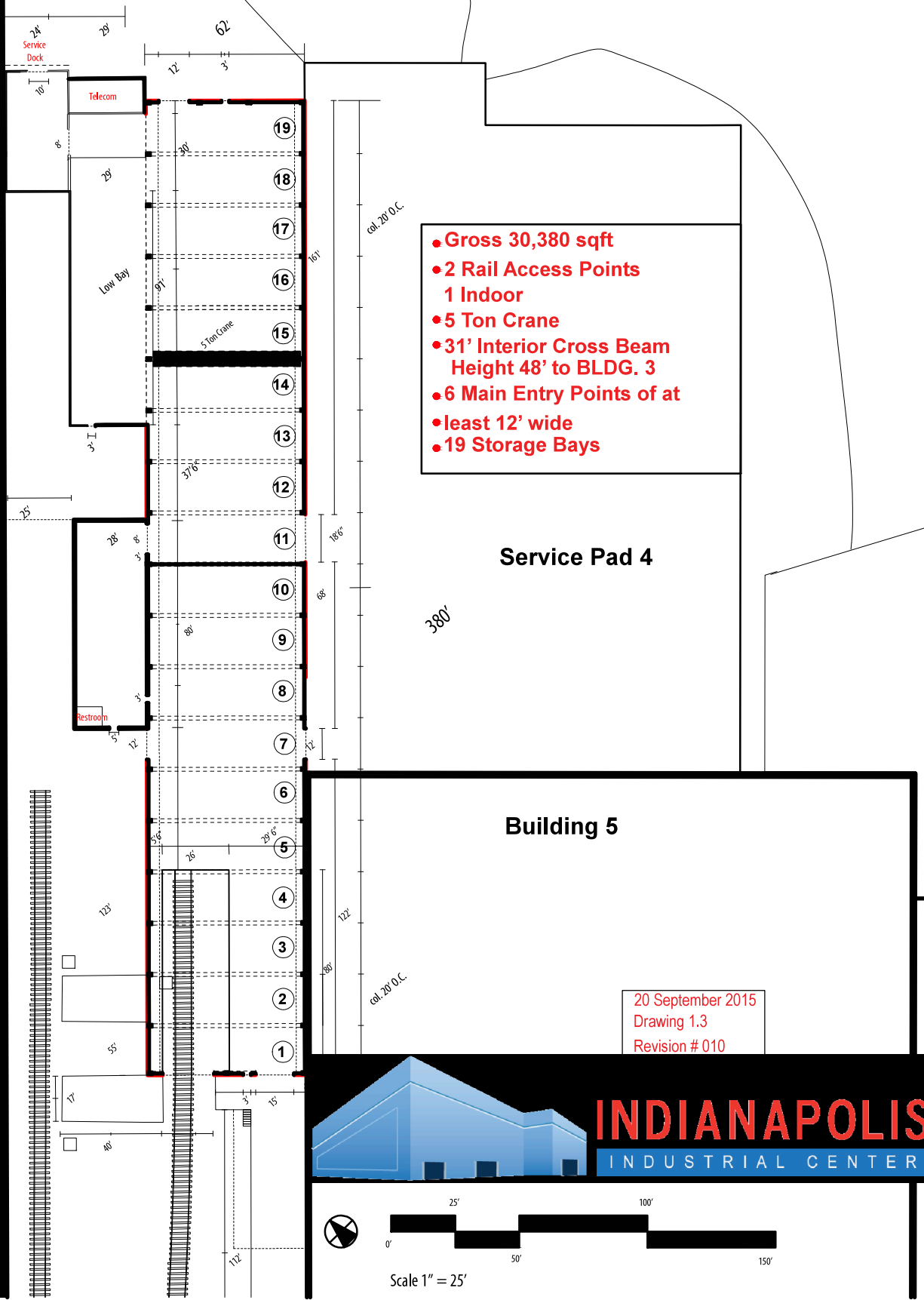

- Gross 30,380 sqft
- 2 Rail Access Points
- 1 Indoor
- 5 Ton Crane
- 31' Interior Cross Beam Height 48' to BLDG. 3
- 6 Main Entry Points of at least 12' wide
- 19 Storage Bays

Service Pad 4

Building 5

20 September 2015
 Drawing 1.3
 Revision # 010

INDIANAPOLIS
 INDUSTRIAL CENTER

